



Door Closer with FRX[®]
Technology
TS 79



new technology

The inexpensive compact quality solution for standard doors assured

With the TS 79 FRX® dormakaba has developed a door closer that rounds off its ClassicLine series perfectly. The ease and speed with which it can be fixed, the fact that its spring strength can be so easily adapted to the door size – by simply turning round the closer arms power shoe and changes in template position allows an easy selection of the closing force to suit various door sizes. Its competitive price should make it the ideal choice for your application.

Certified to ISO 9001.

Benefits

For the trade

- Increased stocking flexibility thanks to the standard ClassicLine series arm.
- Complements the ClassicLine series as a competitive model for standard doors.

For the installer/fabricator

- Non-handed design.
- Easy and quick to fix.

For the architect/specifier

- Competitive and reliable.
- Compact construction combined with classic design.
- Able to withstand up to 4 hour testing. Suitable for fire doors.

For the user

- Constant closing action virtually unaffected by temperature fluctuations.
- Optimum closing speed adjustment with two regulating valves
- Reliable closing with adjustable latching action.

Data and features		TS 79
Spring strength (adjustable by size by power shoe and templating position)	Size	EN 2/3/4
Standard doors	≤ 1100 mm	●
External doors, outward opening		●
Fire doors		●
Non-handed		●
Arm type standard scissor arm		●
Parallel arm bracket		○
Closing speed adjustable at 2 separate valves	180° – 15° 15° – 0°	●
Backcheck		–
Delayed action		–
Hold-open		○
Weight in kg		1.7
Dimensions in mm	Length Overall depth Height	222 41 44
Approved to SS332:2018 Specification for Fire Doors / EN 1634-1 Fire Resistance Test		●

● yes – no ○ optional



The TS 79 FRX® complies with product testing standards and certification requirements with upto 240 mins fire rating, in accordance with SS332:2018 Specification for Fire Doors.



Our innovative FRX® technology meets stricter updated safety standards, giving you the greater peace of mind.

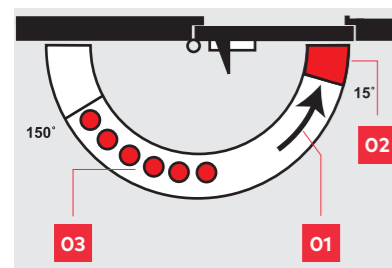

- O1** Closing speed adjustable in the range 180° – 15°.
- O2** Closing speed adjustable in the range 15° – 0°.
- O3** Hold-open range for model with hold-open arm model (optional extra).

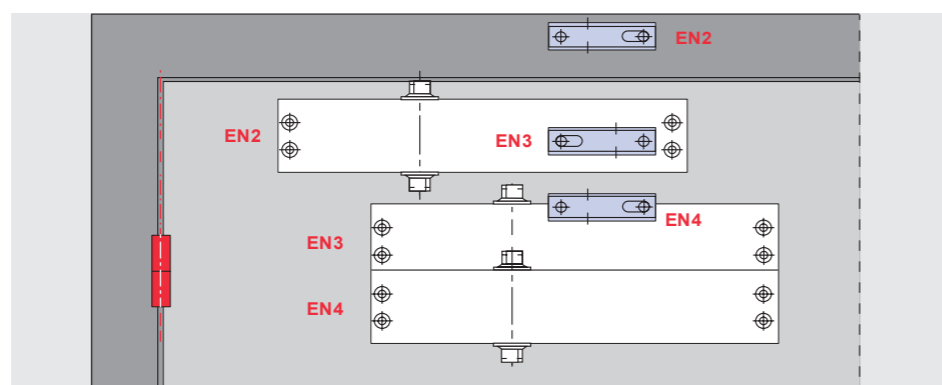
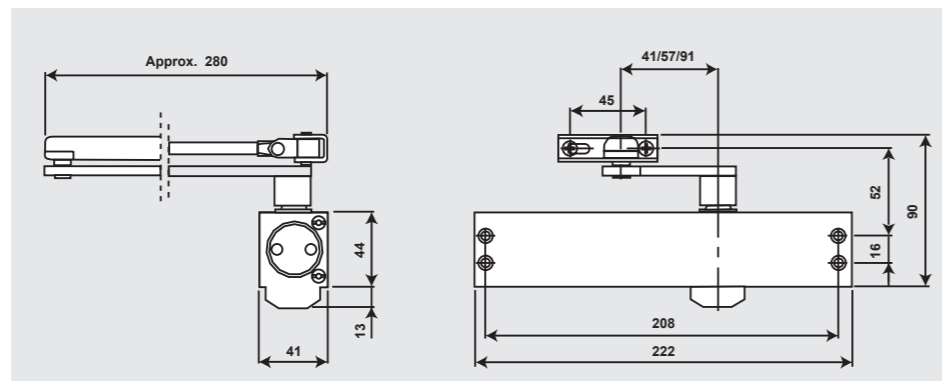

Door width	Size setting
≤ 850 mm	EN 2
≤ 950 mm	EN 3
≤ 1100 mm	EN 4

The TS 79's size setting is selected for the door width by moving the closer body and/or turning the arm power shoe.

Door leaf fixing, pull-side

	EN 2	EN 3	EN 4
A	141	191	191
B	91	57	41
C	62	112	112
D	70	120	120

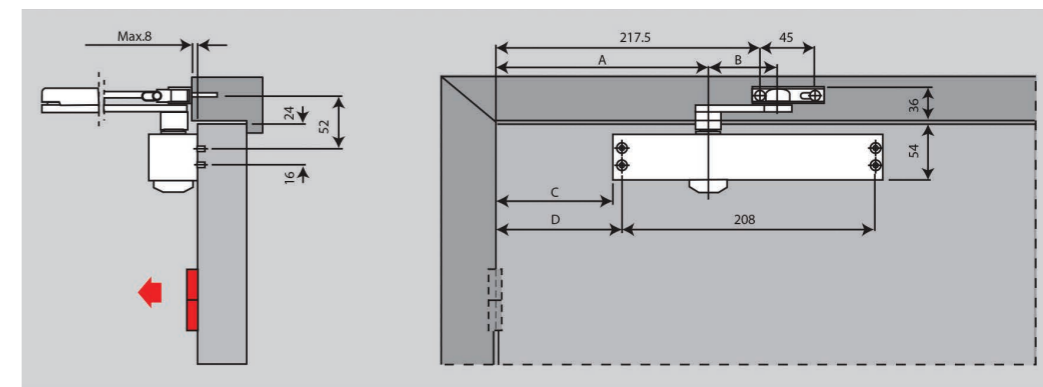

Transom fix (overhead frame installation), push side

	EN 2	EN 3	EN 4
A	141	191	191
B	91	57	41
C	62	112	112
D	70	120	120

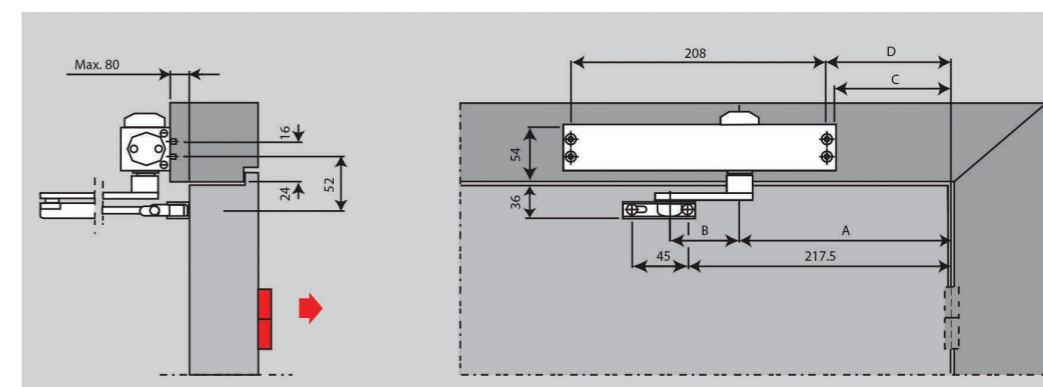

Parallel arm fixing, push side

With this fixing method, the closing force is approx. 20NM (for doors up to 950mm).

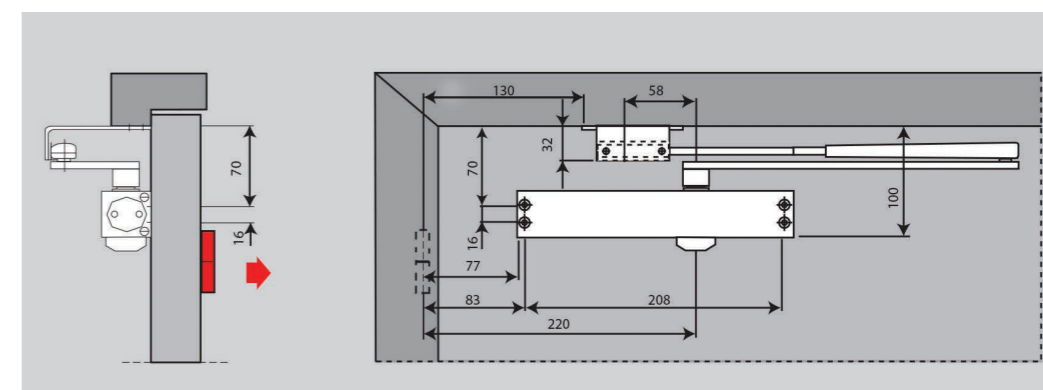

Standard equipment

Order No.

- = Closer body and arm
- = Arm assembly separate
- ▲ = Accessory

Closer body with arm	Standard arm	Hold-open arm	Parallel arm bracket
Size EN 2 / 3 / 4 ■ 9705006816009 Std arm Silver	□ 22002301 Silver	□ 22002501 Silver	▲ 28006601 Silver

Contact Us

Info.ASEAN@dormakaba.com
www.dormakaba.com.sg



Door
Hardware



Electronic
Access & Data



Mechanical
Key Systems



Lodging Systems



Entrance
Systems



Interior Glass
Systems



Safe Locks



Service

dormakaba Singapore Pte Ltd

12 Tukang Innovation Drive #04-01
Singapore 618303
T +65 6268 7633

dormakaba Malaysia Sdn Bhd

No. 3, Jalan TP 6
Taman Perindustrian UEP
47600 Subang Jaya
Selangor Darul Ehsan
T +603 8081 8009

dormakaba Philippines Inc.

Unit 102 RCI Building,
105 Rada St.,
Legaspi Village, Makati City, Philippines
T +632 8893 4077/78

dormakaba (Thailand) Limited

762/2 Room no. A258,
Rama 3 Road Bangpongpan,
Yannawa Bangkok 10120, Thailand
T +66 2059 2612

PT. dormakaba Access Indonesia

Ruko Jalan Ciputat Raya No. 335,
Desa/Kelurahan Kebayoran Lama Utara,
Kec. Kebayoran Lama, Kota Adm. Jakarta
Selatan, Provinsi DKI Jakarta,
Indonesia, 12240
T +62 21 2930 3762

dormakaba Vietnam Rep Office

Centec Business Center, Unit 002, Floor 4,
72-74 Nguyen Thi Minh Khai Street,
Ward 6, District 3, Ho Chih Minh City,
Vietnam
T +84 8 62 99 82 72